

# PARTIALLY SURVEYED TOWNSHIP 0 SOUTH RANGE 0 WEST OF THE WILLAMETTE MERIDIAN, OREGON

Protraction Diagram No. 40, accepted 7/15/1966  
File No. 14 (33FR4215 3/6/1968)

Identifies plat from which unsurveyed lands and protracted acreages were designated.

The unusual method of lotting shown in Section 6 and 7 was used only between 1851 and 1866. Two lot 1's and two lot 2's were designated in the sections along the northern and western boundaries of the township. Patenting part of the lots, as shown in Section 7 created so much confusion that the practice was dropped in favor of the lotting technique used today. The public domain lands in the west half of Section 7 would be described as that part of lot 1 in the NW1/4SW1/4, that part of lot 2 in the NE1/4SW1/4, and that part of lot 2 in the SE1/4SW1/4.

County in which the township is located; if in more than one county, the boundary and names will be shown as below.

**BENTON COUNTY**  
**SALEM - EUGENE**

BLM district or districts in which township is located; district boundaries not depicted.

**BENTON COUNTY** **LANE COUNTY**

TITLE OF PLAT: MT = Master Title  
Lsbl Min = Leaseable Mineral  
Geo = Geothermal Resources  
Coal = Coal

All Oregon and Washington townships are surveyed from Willamette Meridian and base.

**STATUS OF PUBLIC DOMAIN LAND AND MINERAL TITLES AND ACQUIRED LANDS**

**MT PLAT**

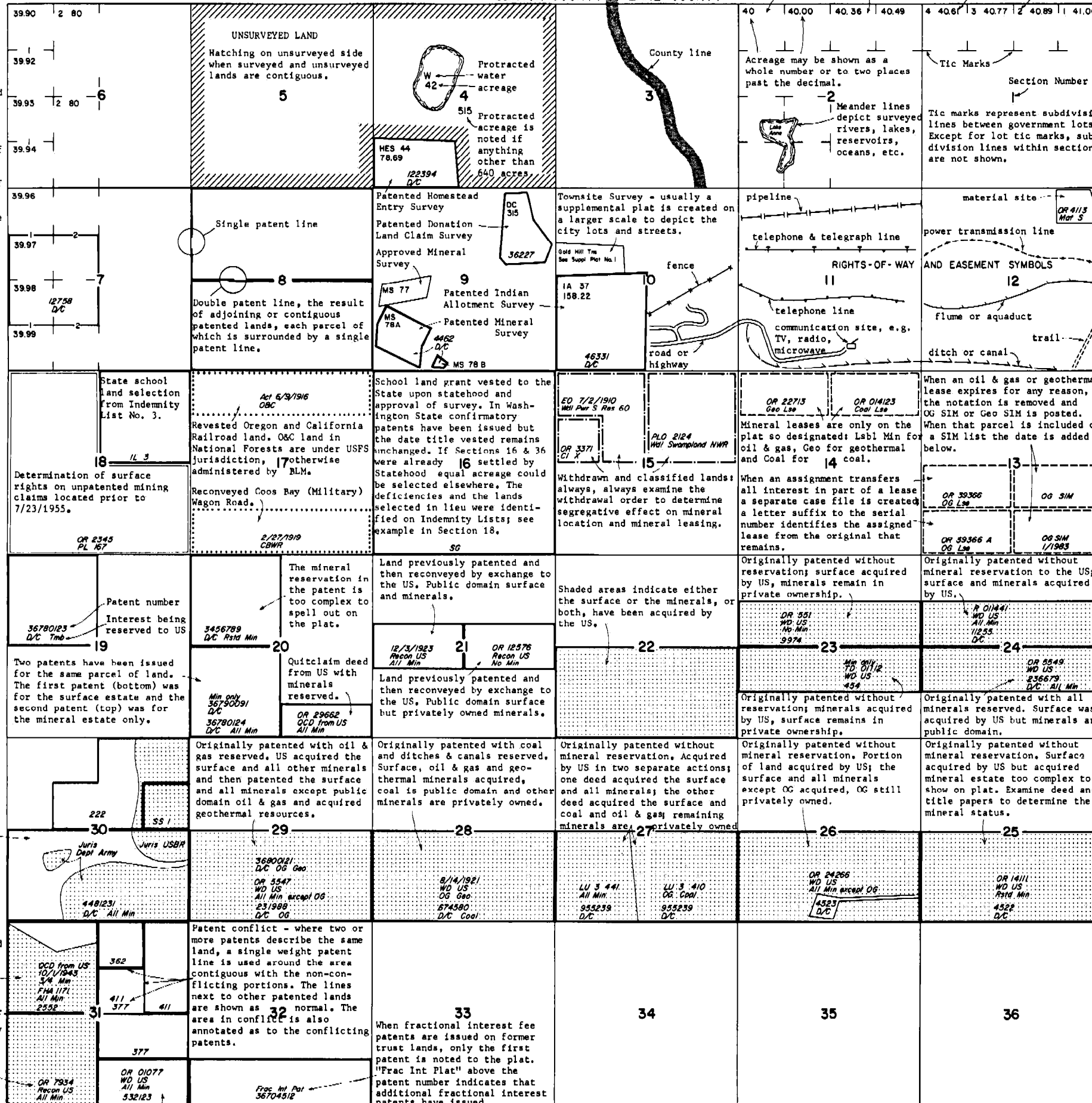

INDEX TO SEGREGATED TRACTS				
RESURVEY	ORIGINAL SURVEY			
TRACT NO	T	R	SEC	SUBDIVISION

FOR ORDERS EFFECTING DISPOSAL OR USE OF UNIDENTIFIED LANDS WITHDRAWN FOR CLASSIFICATION, MINERALS, WATER AND/OR OTHER PUBLIC PURPOSES, REFER TO INDEX OF MISCELLANEOUS DOCUMENTS.

OR 123 WD to US (Acq)  
Sec 12: MBB 103 A  
Survey Pending Group 977  
Secs 1, 2, 11 thru 15, 24

PLO 2345 Det PL 167 (Act of Cong 7/23/1955) completed 1/1/1965, all PD surface Mgmt by BLM except Sec 33: Joe Blow Lodge

PLO 2346 1/1/1958 All lands or interests in lands within 1 mile of Rogue River, Acq by US, Res for Rec area

Status Undet See GLO Ltr "N" 1/1/1905  
Sec 2: NE1/4NE1/4

SO 11/24/1925 Pwr S Res 60, OE Subj to Sec 24 FPA  
Sec 29: S1/4NE1/4

1/20/1905 House Bill No. 1, State of Oregon Cession Laws, ceded certain land to USBR

OR 7596 Wdl Mt Jefferson Wilderness  
Secs 1, 2, 11, 12 MBB

All Tp included in Wdl Mt Hood NF  
EO 3944 1/21/1924

OR 12676 Breitenbush Hot Springs KGRA  
36FR5626 3/25/1976 Secs 10 thru 16, 22, 23

PLO 1511 9/24/1957 Wdl Malheur NWR  
All public land within meander lines of Malheur and Harney Lakes

OR 22023 Conservation Esmt to US  
Sec 14: MBB 0.32 A

**SAMPLE MARGIN ENTRIES:**  
Margin entries are made when documents, actions or status information can't be depicted due to insufficient information, lack of appropriate record notation standards, or other extenuating circumstances.

Plat is date stamped each time a notation is made and a film record generated. When copies are furnished to the public a second date stamp appears below.

CURRENT TO	BY
AUG 30 1984	
OCT 3 1982	

Some lands have been identified as acquired by other Federal agencies. However, as complete documentation has not been provided to BLM, these lands are noted only as to which agency has jurisdiction. The managing agency must be contacted to determine surface and mineral status.

Originally patented without mineral reservation. Acquired by FHA and later quitclaimed from FHA with 3/4ths of all minerals reserved to the US. PL 760 later transferred jurisdiction of the acquired minerals to Dept. of Interior Weeks Act Exchange - the only occasion in which land received by the US in exchange of public domain land takes on acquired land status.

Land conveyed to the US in exchange for acquired US land is considered public domain. Unlike other exchanges the record notation shows "WD US" rather than "Recon US". This type of exchange can be distinguished from acquisitions by the absence of shading.

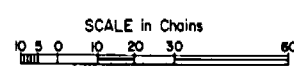

The original record is drawn to a scale of thirty chains to the inch. However, due to variable lense ratios used in filming the record (16X) and making copies for public inspection (10X, 14.5X), 1:1 reproduction of the record is not possible. Other states using different types of film processes or equipment may be able to provide 1:1 reproduction.

Will Mer  
T. O S  
R. O W